

LED Beacons Series R

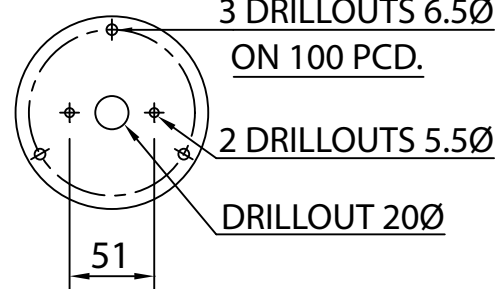
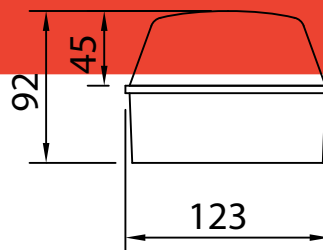

PSR Low-power warning beacon with single-flash, triple-flash, random-flash and static operating modes. Internal DIP switch to select operating mode:

Mode	Ref	Description
Static	Static	Beacon operates continuously without flashing
Single Flash	SH	Flash-Pause
Triple Flash	TH	Flash-Flash-Flash-Pause
Random Flash	RF	

Comprising a robust White ABS Base, and a Polycarbonate lens. Circuitry is fixed to the base assembly, with convenient access to the terminal block for wiring, allowing easy fitting of bases and wiring during installation.

		PSR/DC/10-40/LED	PSR/UC/115-230/LED
Supply Voltage		10-40Vdc	115-230Vuc (ac or dc)
Minimum Supply Voltage		10Vdc	97Vuc
Maximum Supply Voltage		40Vdc	265Vuc
Average Current Draw (Static/SH/TH/RF)		53 / 33 / 53 / 104 mA (@24Vdc)	33 / 23 / 19 / 23 mA (230Vac)
Peak Operating Current (Static/SH/TH/RF)		111 / 112 / 150 / 112 mA (@24Vdc)	181 / 161 / 165 / 161 mA (230Vac)
Nominal power consumption (Static/SH/TH/RF)		2.5 / 1.3 / 0.8 / 1.3 W (@24Vdc)	3.6 / 2.2 / 1.6 / 2.3 W (230Vac)
Flash Rate	Factory Set	120 fpm (2Hz)	
	Other	0 fps - Static / 6 fps - TH / Random	
Luminous Intensity	Red	18 Cd	
	Amber	81 Cd	
	Green	35 Cd	
	Blue	23 Cd	
	Clear	188 Cd	
Angle of max rated brilliance		On axis with front face	
Recommended fuse rating		External - 500mA TD	
IEC protection class		IP65	
Operating Temperature Range		-40 to +55 Degrees C	
Net Product Weight		238g	243g