

Sounders Series IAS-T

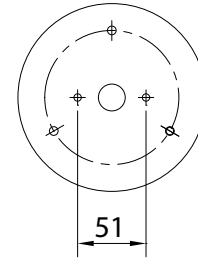
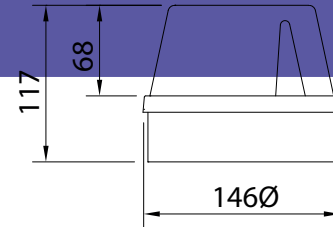

114dB (Max) multi-tone sounder.

Compatible with full Series T, U and V ranges to provide a fully customised and integrated signalling solution.

Circuitry is fixed to the horn assembly, with convenient access to the terminal block for wiring, as well as tone selector switch and volume control, allowing easy fitting of bases and wiring during installation, and safe storage of the electronics for phase 2 fitting.

Cap is fastened to the base with a custom gasket and secured by three screws.

- Dedicated Electronic Sounders for general-purpose audible alarm applications.
- 114dB (A) max. IP66 64-tone electronic sounder with internal volume control.
- Each of the 64 tone combinations are selected using an internal DIP-switch array.
- Simple 2-wire connection to energise sounder with second-stage and third-stage tones available on third/fourth wires.
- Full range of supply voltages accommodated - 10-30Vdc, 24Vac, 115-230Vuc and 45-65Vac/55-95Vdc units available. (uc = ac or dc)
- Features Black Polycarbonate base with either Red horn (Versions with Black or White horns also available).
- Supplied with cable gland and anti-condensation breather element.

Sounders Series IAS-T

Switch Setting	Tone No	Tone Description	2nd Tone	3rd Tone	dBA	Is	dBA@All	Is	Arms	Arms	Arms	Arms
					@12Vdc	12Vdc (mA)	other Voltages	24Vdc (mA)	24Vac (mA)	48Vac (mA)	115Vac (mA)	230Vac (mA)
123456												
000000	1	420 INT @ 625mS/625mS (aus evac)	22	55	92	15	95	28	53	14	12	7
100000	2	554/440 ALT @ 0.1S/0.4S	14	51	92	23	96	37	67	20	16	10
010000	3	554/440 ALT @1Hz	3	55	98	25	102	38	69	21	17	10
110000	4	660	4	55	89	29	94	43	79	27	22	12
001000	5	660 INT 1S on/1S off	5	11	88	19	94	31	58	17	14	9
101000	6	660 INT @ 1.8S on/1.8S off	6	55	89	19	94	31	57	17	14	9
011000	7	660 INT @ 6.5S on/13S off	7	26	90	15	94	27	50	14	12	7
111000	8	800/970 ALT	14	25	100	39	104	50	90	30	25	14
000100	9	800/970 ALT @1Sec/1Sec	14	23	102	39	106	49	89	30	24	14
100100	10	800-970 SWEEP @1Hz	14	55	102	39	105	50	88	30	24	14
010100	11	800-970 SWEEP @7Hz	14	55	102	39	105	49	87	29	25	14
110100	12	800-970 SWEEP @50Hz	14	55	102	39	105	49	87	30	25	14
001100	13	800-970-800 SWEEP @1/1Hz	14	24	102	39	106	50	87	30	25	14
101100	14	970	14	11	102	40	106	49	87	21	27	16
011100	15	970 INT @1Hz	14	25	102	23	106	34	62	20	17	10
111100	16	660 INT @ 150mS/150mS	16	55	84	19	88	31	59	20	16	10
000010	17	970 INT 0.5s on / 0.5s off	17	51	97	24	100	33	61	22	20	11
100010	18	970 INT @0.25s ON/1S OFF	14	21	91	14	95	28	48	16	14	8
010010	19	1000 (toxic gas alarm)	21	20	99	39	102	50	86	33	28	16
110010	20	1000 INT @1s/1s (gen alarm)	21	23	98	23	102	35	63	21	17	11
001010	21	1200-500 SWEEP @1Hz (papa)	20	8	97	31	100	44	81	27	22	13
101010	22	2100-1000 SWEEP @ 500mS	23	56	90	55	95	72	137	53	41	25
011010	23	1600/2100 ALT @250mS/250mS	24	11	92	106	95	124	217	85	63	40
111010	24	1600-2100-1600 SWEEP @ 1s/1s	23	52	93	103	96	122	209	84	66	42
000110	25	2400/2850 ALT	29	30	109	173	112	162	267	115	86	57
100110	26	2400-2850 SWEEP @1Hz	29	20	111	172	113	157	264	120	85	59
010110	27	2400-2850 SWEEP @7Hz	29	55	111	167	113	155	261	120	87	59
110110	28	2400-2850 SWEEP @50Hz	29	55	111	166	113	155	259	117	87	59
001110	29	2850	14	49	112	154	114	143	240	114	93	65
101110	30	2850 INT @1Hz	29	28	111	84	113	85	144	63	50	34
011110	31	2850 INT 0.5s on / 0.5s off	31	55	106	87	109	84	170	79	65	39
111110	32	2850 INT 150ms on / 100ms off	14	13	107	99	110	99	195	89	72	46
000001	33	660 Hz INT @ 150mS/150mS	56	52	84	19	88	31	59	20	16	10
100001	34	660 Hz INT @ 150mS/150mS	56	4	84	19	88	31	59	20	16	10
010001	35	660 Hz INT @ 150mS/150mS	56	46	84	19	88	31	59	20	16	10
110001	36	660 Hz INT @ 150mS/150mS	57	52	84	19	88	31	59	20	16	10
001001	37	660 Hz INT @ 150mS/150mS	57	4	84	19	88	31	59	20	16	10
101001	38	660 Hz INT @ 150mS/150mS	57	46	84	19	88	31	59	20	16	10
011001	39	660 Hz INT @ 150mS/300mS	56	52	83	15	87	27	55	16	13	8
111001	40	660 Hz INT @ 150mS/300mS	56	4	83	15	87	27	55	16	13	8
000101	41	660 Hz INT @ 150mS/300mS	56	46	83	15	87	27	55	16	13	8
100101	42	660 Hz INT @ 150mS/300mS	57	52	83	15	87	27	55	16	13	8
010101	43	660 Hz INT @ 150mS/300mS	57	4	83	15	87	27	55	16	13	8
110101	44	660 Hz INT @ 150mS/300mS	57	46	83	15	87	27	55	16	13	8
001101	45	660 Hz INT @ 6.5S on/13S off	47	48	90	15	94	27	50	14	12	7
101101	46	300 Hz Continuous	8	55	94	18	98	31	57	16	13	8
011101	47	800 Hz INT @ 6.5S on/13S off	56	20	94	18	98	29	57	15	12	8
111101	48	300 Hz INT @ 6.5S on/13S off	51	53	94	11	97	23	44	10	8	6
000011	49	340 Hz Continuous	8	55	90	19	93	32	60	17	14	9
100011	50	440 Hz Continuous	8	55	90	22	93	36	65	20	17	10
010011	51	554 Hz Continuous	22	55	98	26	101	39	72	23	18	11
110011	52	800 Hz Continuous	8	55	95	38	98	49	90	32	24	13
001011	53	1200 Hz Continuous	8	55	87	38	92	52	93	33	29	17
101011	54	2000 Hz Continuous	23	20	94	130	98	142	238	110	75	47
011011	55	2400 Hz Continuous	13	4	107	183	110	177	288	125	79	51
111011	56	800 Hz INT @ 0.8S on/0.8S off	11	27	93	26	97	38	64	22	16	9
000111	57	660 Hz INT @ 0.8S on/0.8S off	56	21	87	19	92	34	59	19	16	9
100111	58	1000 Hz INT @ 1s/1s (gen alarm)	54	21	98	23	102	35	63	21	17	11
010111	59	800-970 Hz SWEEP @ 1Hz	22	26	102	39	105	50	88	30	24	14
110111	60	800 Hz Continuous	20	27	95	38	98	49	90	32	24	13
001111	61	800-970-800 Hz SWEEP @ 1/1Hz	19	32	102	39	106	50	87	30	25	14
101111	62	1000 Hz (toxic gas alarm)	54	29	99	39	102	50	86	33	28	16
011111	63	2400 Hz Continuous	25	27	107	183	110	177	288	125	79	51
111111	64	1600/2100 Hz ALT @ 250mS/250mS	21	29	92	106	95	124	217	85	63	40