

Rotating Mirror Beacons Series RFH/RMLED

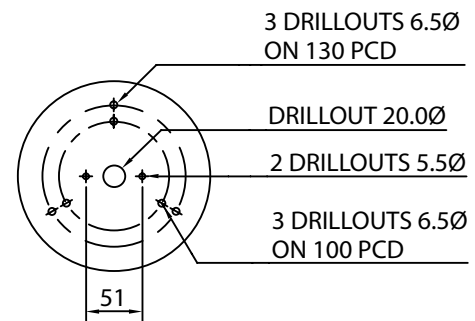
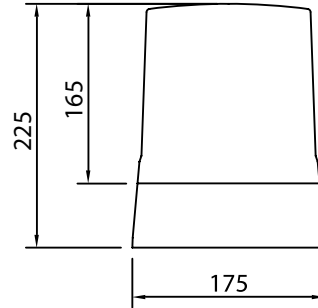

A traditional rotating mirror beacon with solid state LED light source. Extremely high light output and a very pure colour obtained from using the same colour LED as beacon lens. Red, Amber, Green, Blue, Clear colour options are available.

Extremely low power, typically less than 7W, makes it suitable for fire and security systems, and for systems which feature battery back-up in case of failure of the primary power source. The Ultra-low current draw means more units can be powered from a single source.

Two voltage options are available; 12-55Vdc and 115-230Vuc (uc = ac or dc).

| | | RFH/DC/12-55/RMLED | RFH/UC/115-230/RMLED |
|-------------------------------|------------------|----------------------|----------------------|
| Supply Voltage | | 12-55Vdc | 115-230Vuc |
| Minimum Supply Voltage | | 12Vdc | 98Vuc |
| Maximum Supply Voltage | | 55Vdc | 264Vuc |
| Average Current Draw | Red/Amber | 178mA (@24Vdc) | 51mA (@230Vuc) |
| | Green/Blue/Clear | 251mA (@24Vdc) | 65mA (@230Vuc) |
| Peak Operating Current | | 605mA (@12Vdc) | 364mA (@115Vuc) |
| Nominal power consumption | Red/Amber | 4.3W (@24Vdc) | 5.0W (@230Vuc) |
| | Green/Blue/Clear | 6.0W (@24Vdc) | 6.7W (230@Vuc) |
| Flash Rate | | 150fpm (2.5Hz) | |
| Luminous Intensity | Red | 146Cd | |
| | Amber | 232Cd | |
| | Green | 308Cd | |
| | Blue | 220Cd | |
| | Clear | 870Cd | |
| Angle of max rated brilliance | | 0 Degrees Vertical | |
| Recommended fuse rating | | External - 500mA TD | |
| IEC protection class | | IP65 | |
| Operating Temperature Range | | -40 to +55 Degrees C | |
| Net Product Weight | | 1.02Kg | |