

Xenon Strobe Beacons Series C

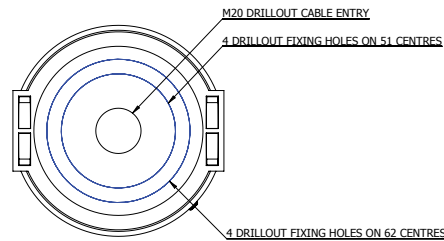
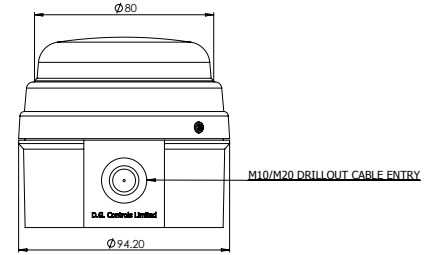
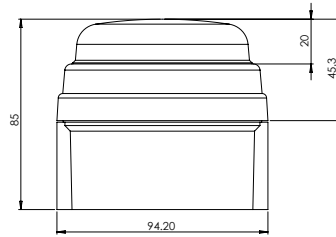

2 joule and 5 joule xenon strobe warning beacons.

Extensively configurable, comprising a robust White (standard) or Red (option) ABS Base, and a Polycarbonate lens. Multiple units from the Series C range can be joined together, including the matching IAS-C Sounder, to provide an integrated signalling system.

Circuitry is fixed to the lens assembly, with convenient access to the terminal block for wiring, allowing easy fitting of bases and wiring during installation, and safe storage of the electronics and lenses for phase 2 fitting.

Lenses are fitted to the bases by bayonet fitting with an O-ring seal, secured by a single securing grub screw. There are no other external fixings, and all connections between enclosure parts are protected by O-rings.

	XFC/DC/12-24/SH/2J	XFC/AC/115/SH/2J	XFC/AC/230/SH/2J	XFC/DC/12-24/SH/5J	XFC/AC/115/SH/5J	XFC/AC/230/SH/5J
Supply Voltage	12-24Vdc	115Vac	230Vac	12-24Vdc	115Vac	230Vac
Minimum Supply Voltage	10.2Vdc	97.8Vuc	195.5Vac	10.2Vdc	97.8Vuc	195.5Vac
Maximum Supply Voltage	27.6Vdc	132.2Vac	264.5Vac	27.6Vdc	132.2Vac	264.5Vac
Average Current Draw	127mA*	73mA	40mA	274mA*	137mA	85mA
Peak Operating Current		1.4A	110mA		3.6A	220mA
Nominal power consumption	1.8-3W	3.8W	3.6W	3.4-6.6W	7W	7.4W
Flash Rate	65fpm 1.08Hz					
Luminous Intensity	Red	10Cd*	10Cd	10Cd	13Cd*	20Cd
	Amber	37Cd*	30Cd	30Cd	47Cd*	54Cd
	Green	27Cd*	25Cd	25Cd	39Cd*	44Cd
	Blue	9Cd*	9Cd	9Cd	12Cd*	18Cd
	Clear	49Cd*	51Cd	51Cd	82Cd*	90Cd

Angle of max rated brilliance On axis with front face

Recommended fuse rating External - 500mA TD

IEC protection class IP65

Operating Temperature Range -20 to +55 Degrees C

Net Product Weight 165g 165g 165g 198g 179g 188g